



History remains untouched in this carefully orchestrated redesign.



"washington dined here"

The current owner of the Havermeyer Mansion, a fine example of early American architecture dating back to the 1700's, was restoring the home before it was selected as the 2000 Showhouse for *House & Garden* magazine. Because of historic restrictions (George Washington was headquartered here during the American Revolution), the existing windows, doors, and hearth fireplace could not be altered in any way.

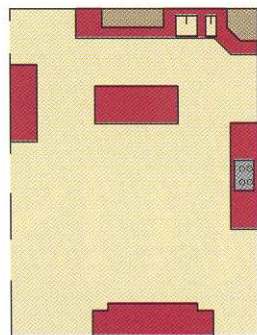

Amir J. Ilin and Don DiNovi, CKD, professional designers with Kuche + Cucina, decided to provide the

kitchen with a feeling of fine furniture throughout the room. These new kitchen elements were designed to look as if they were added at different times during the life of the mansion. The refrigerator was incorporated into a pantry cabinet, the dishwasher was hidden from sight, and the sophisticated lazy susan and special velvet lined silverware drawers were integrated into the painted SieMatic cabinetry.

White cracked enameled counters, wood block tops, and a large hood make the room seem as though it had been designed two hundred years ago, while the hand-made backsplash tile, walls and stenciling provide custom touches to a home whose history is as unique as its renewed design. ●

Special Features:

Pyrolave — lava stone, enameled counter, Rohl-pot filler, Cobsa — hand-made backsplash tile, hand painted walls and stenciling.

Dimensions:

26 feet by 19 feet

Products Used:

Cabinetry: SieMatic Hudson Valley Collection; Flooring: Bruce wood floor/Hoboken floors; Countertops: white enamel — Pyrolave, Wood counters — SieMatic; Sink(s): Kohler; Faucets: Rohl; Dishwasher: Gaggenau; Lighting: Urban Archeology; Refrigerator: Sub-Zero 700; Stove: Garland.

